

INST_80_129

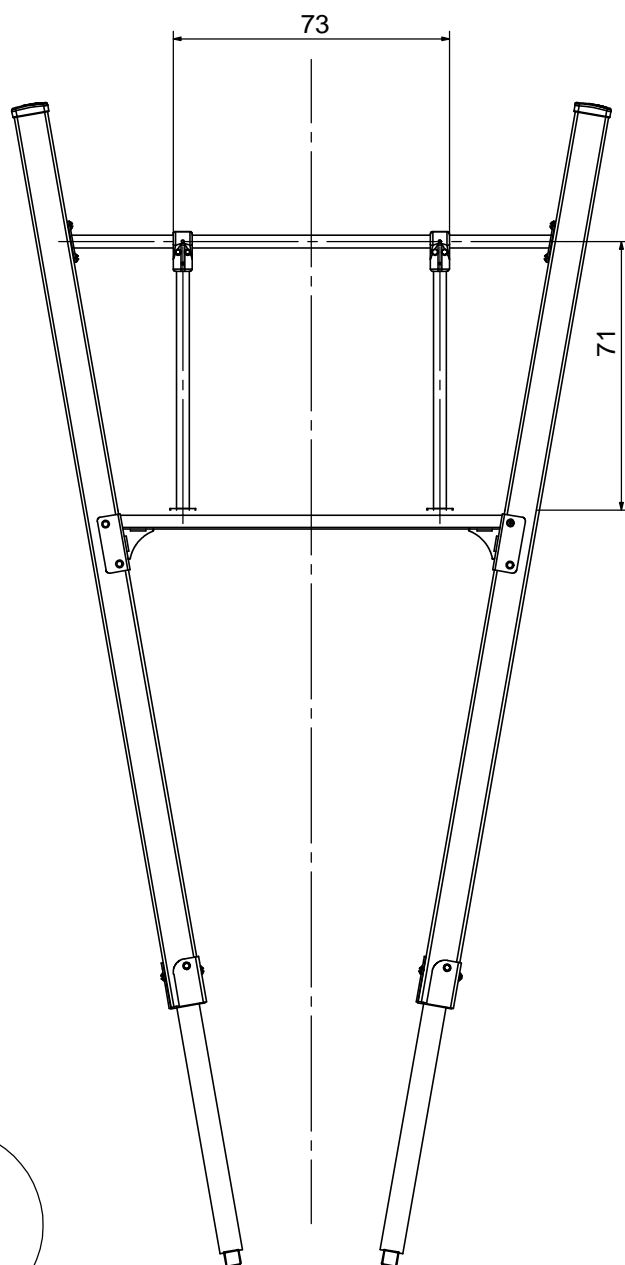

Nr:	Σ	Element:	
1	x16	S6x60	
2	x16	W6x60	
4	x6	DIN 125 - 10x20	
14	x4	ISO 7380 - M6x12	
21	x20	DIN 125 - 8x16	
22	x20	DIN 125 - 6x12	
24	x16	ISO 7380 - M6x16	
29	x12	K_5_A2_g2_G_v2	
43	x4	DIN 1587 - M8	
57	x6	DIN 1587 - M10	
81	x6	ISO 7380 - M10x35	
84	x4	ISO 7380 - M8x35	
88	x2	Aluz RR	
115	x6	Aluz PD	
147	x20	BN M6x10	

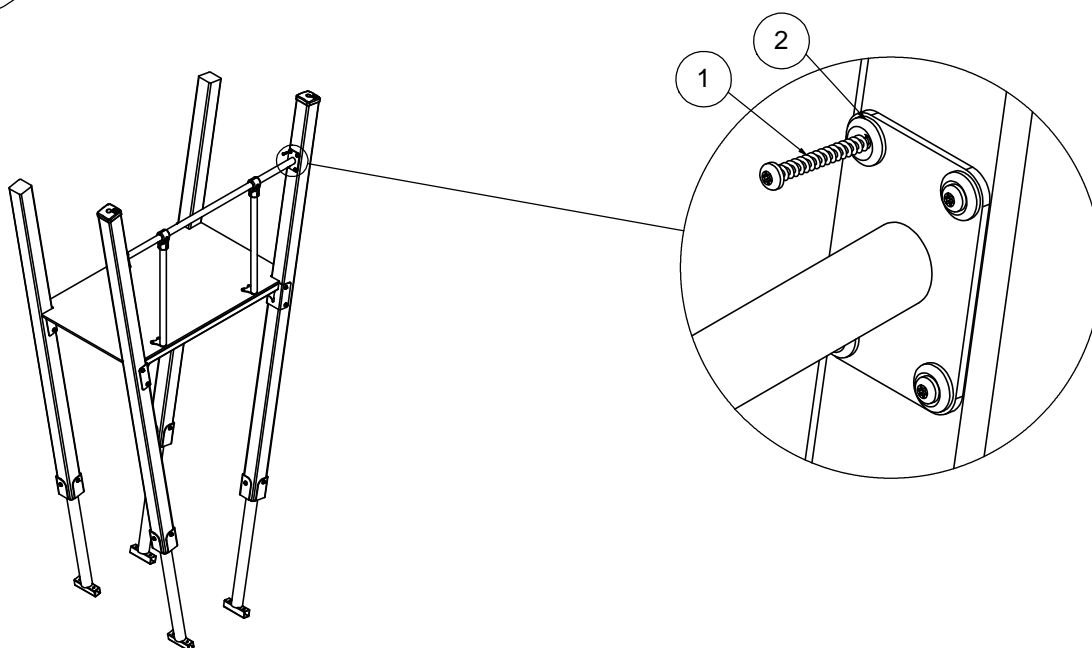

2

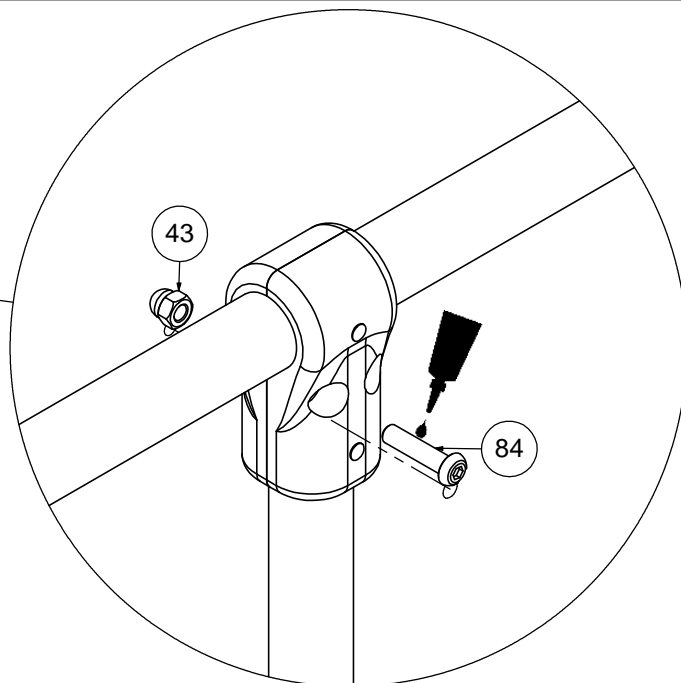
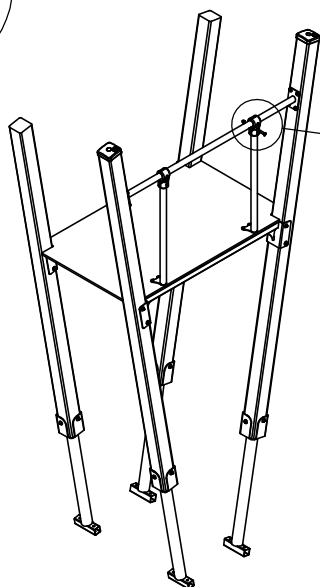

3

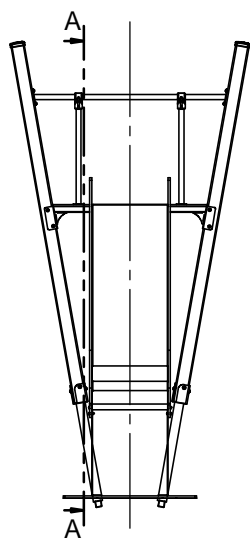

A-A

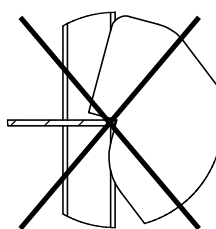
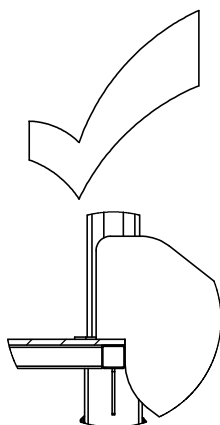
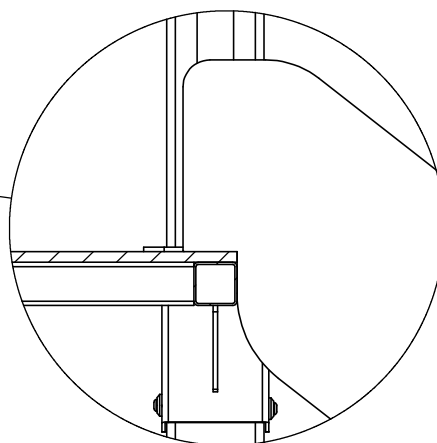
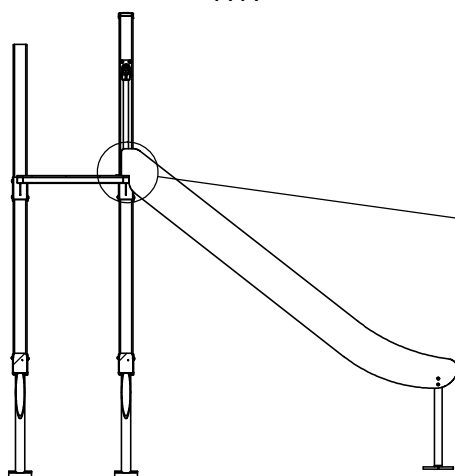

4

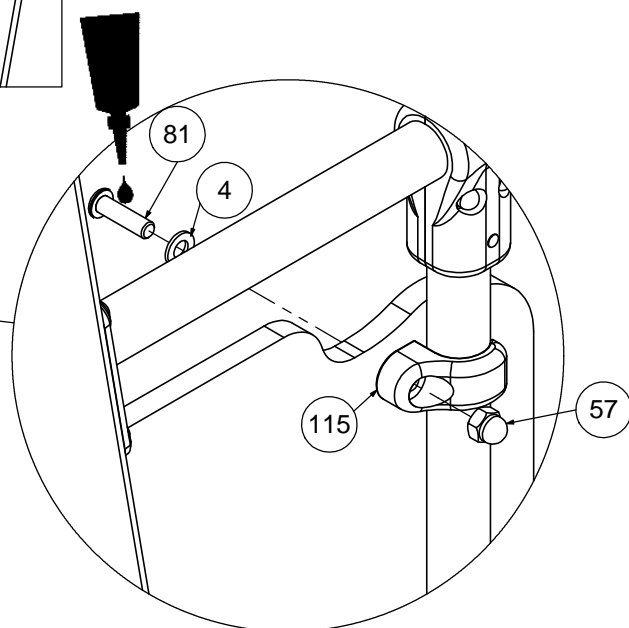
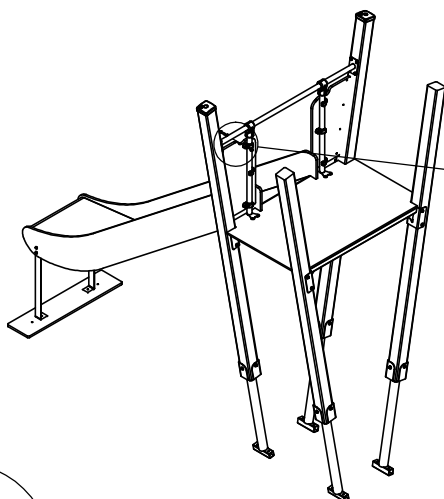
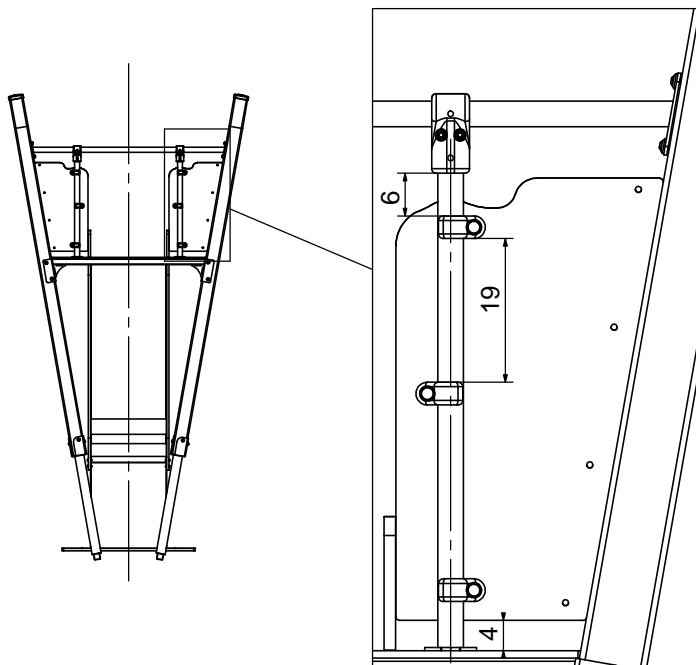

5

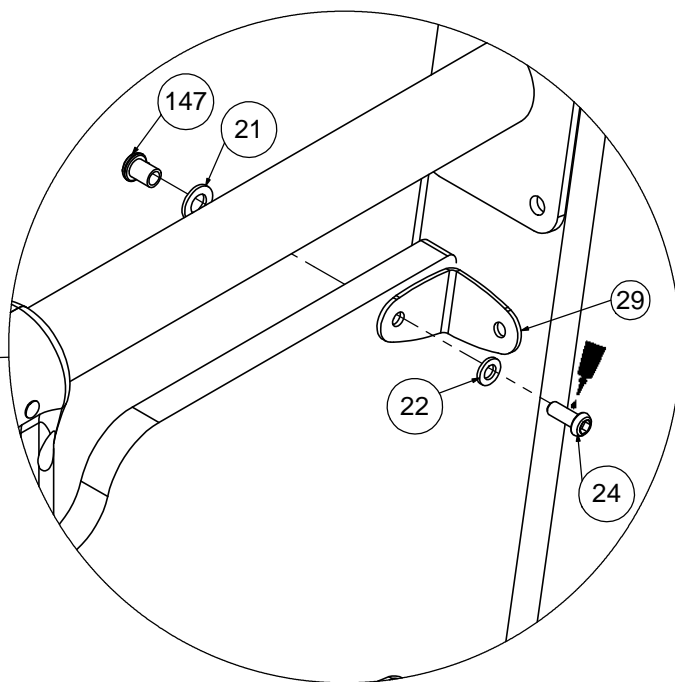
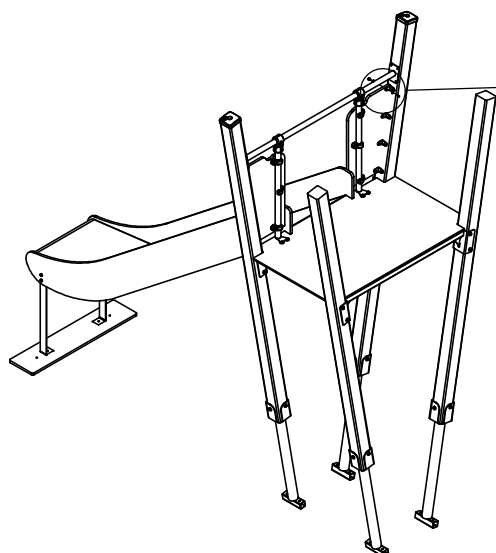

6

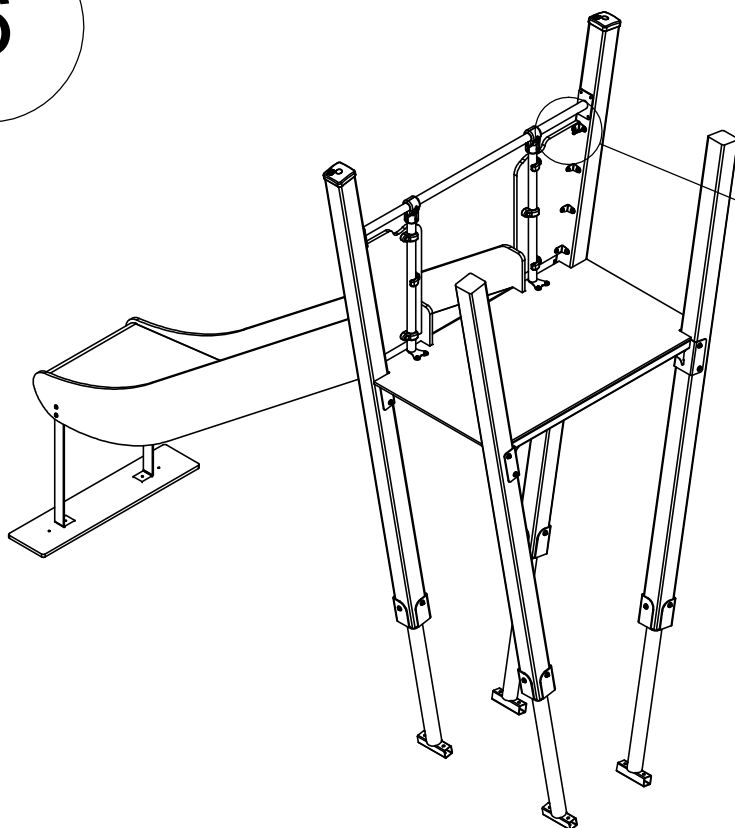

7

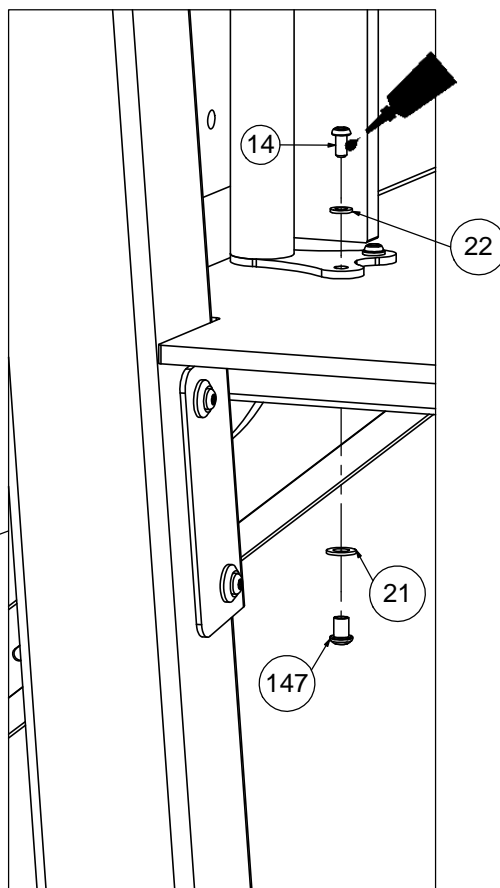
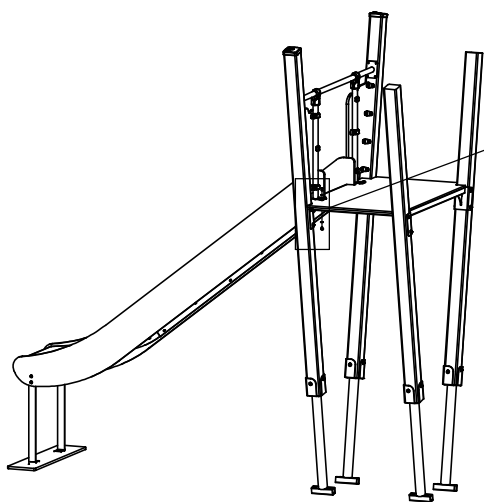

8

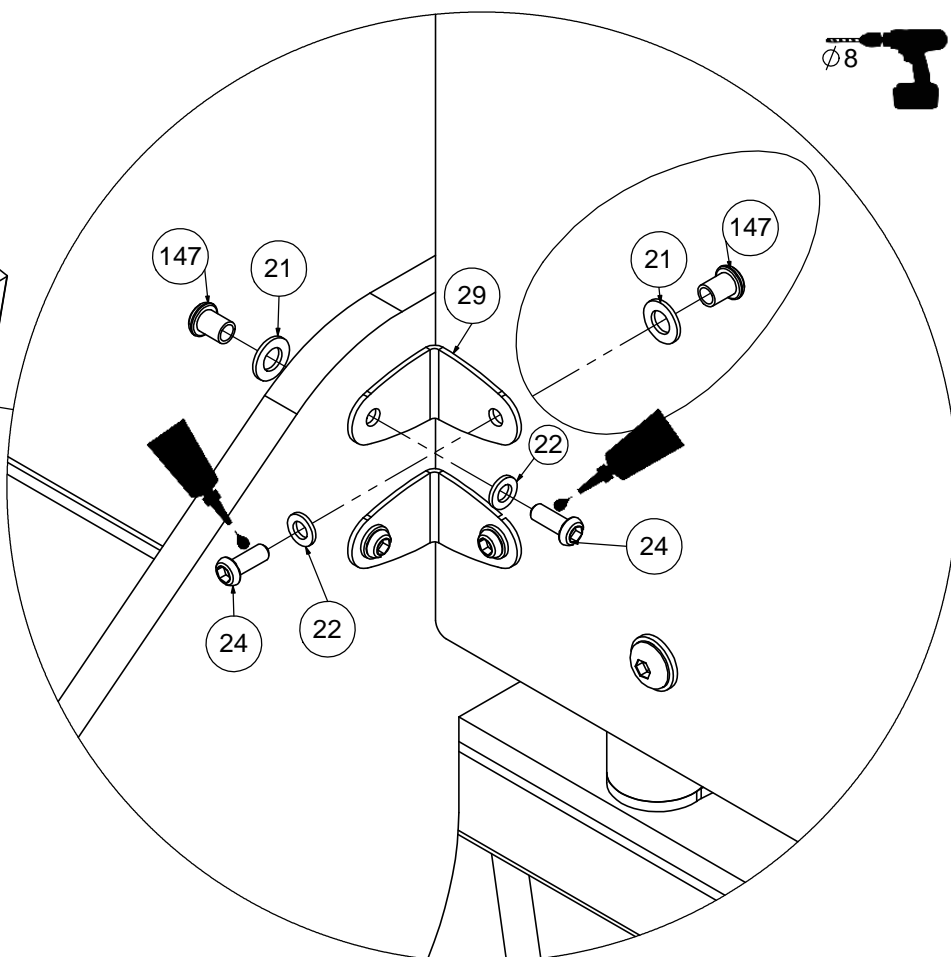
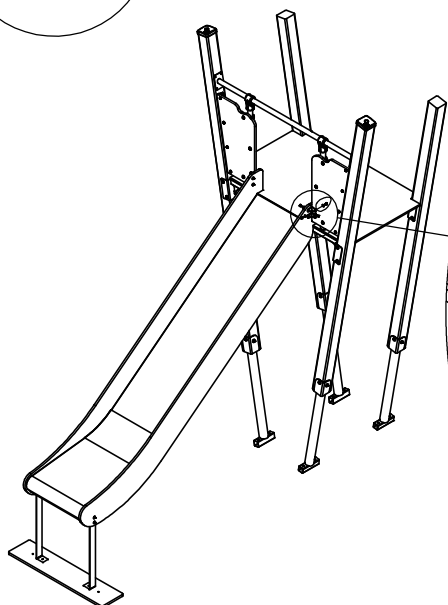
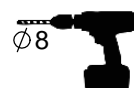

F

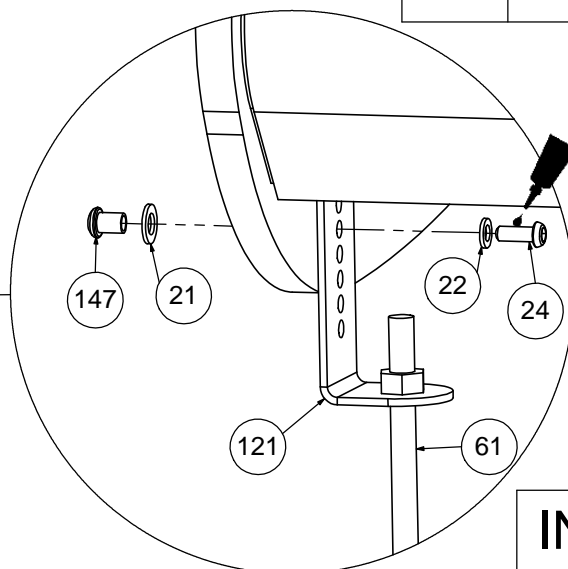
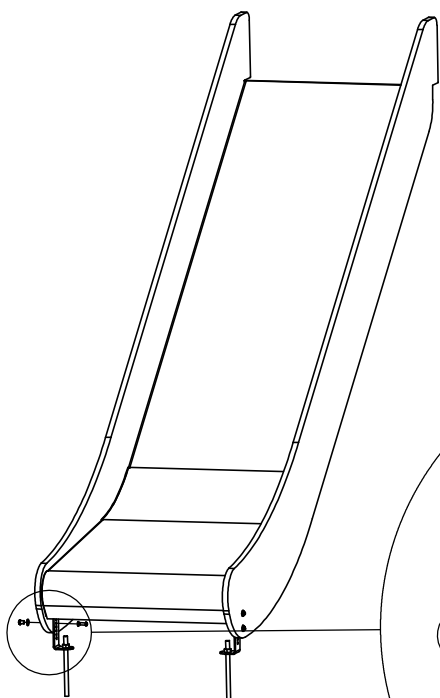

Nr.	Σ	Element:	
21	4x	DIN 125 - 8x16	
22	4x	DIN 125 - 6x12	
24	4x	ISO 7380 - M6x16	
61	2x	KL105	
136	2x	7100_5_A2_g3_G_v1	
147	4x	BN M6x10	